

# Splash<sub>2</sub>o Aqua-Tower Manifold Assembly Replacement Instructions

## PREPARATION:

- Disconnect unit from water supply and drain reservoir
- Remove all Aqua-Stations
- Get 3 small flat tip tools such as flat head screwdrivers, and a snipper

### 1. Remove top hub from your current Aqua-Tower

- Start with your Aqua-Tower's upper column extended with the upper arms lowered down
- To release locking tabs, carefully insert and wedge a flat tip tool into each of the 3 slots under the top hub. While tools are still wedged in, pull the top hub up to disconnect it from the upper column.
- While holding top hub, lower upper column and disconnect the connector; set top hub assembly aside.

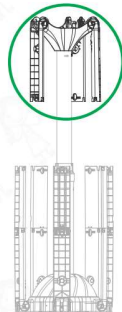

Figure 1A

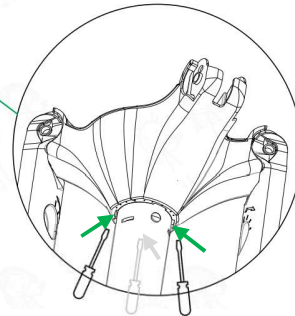

Figure 1B

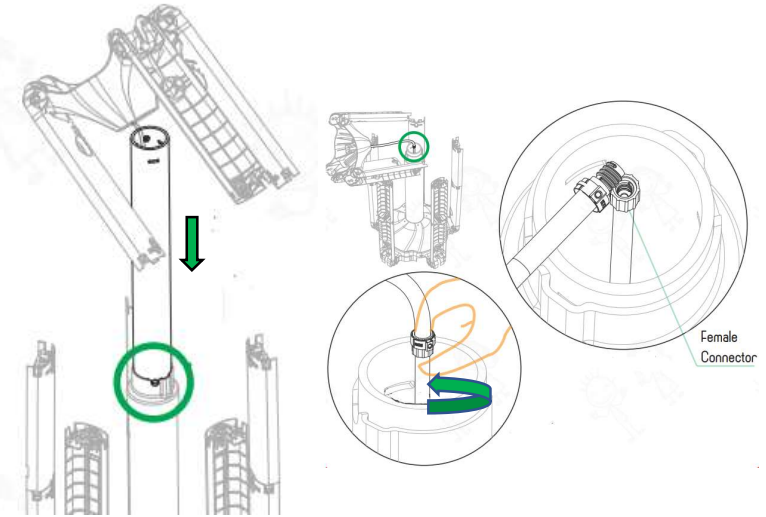

Figure 1C

### 2. Disconnect manifold assembly from base and install new manifold assembly

- Rotate upper column into locked position, and carefully turn the base assembly upside down; have another person hold it in place for the following steps, so that it does not fall over
- Disconnect the 5 hose connections at the bottom
- Remove inlet hose connector by turning its stem counterclockwise (may need a pair of pliers to loosen). Turning the collar where the hose connects will **not** loosen the connector.
- Before starting this step, note the orientation and hose routing of the manifold assembly in place. Using a snipper, cut the hose leading to the base fill valve at the bend as well as the manifold zip tie, and then pull the manifold assembly out
- First route new zip tie through the holes of the old one, and then insert replacement manifold assembly in the same orientation and hose routing as noted in Step 2D
- Insert hose clamp over the end of the cut hose, and push elbow fitting into the hose. Position hose clamp over the elbow and tighten hose clamp before securing manifold with the zip tie
- Fasten inlet hose connector and tighten securely to ensure there are no leaks during operation.
- Reconnect the 5 hose connectors for the arms.

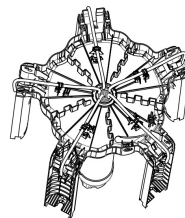

Figure 2A

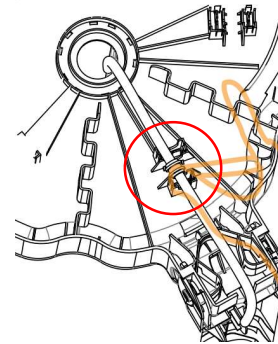

Figure 2B & 2H

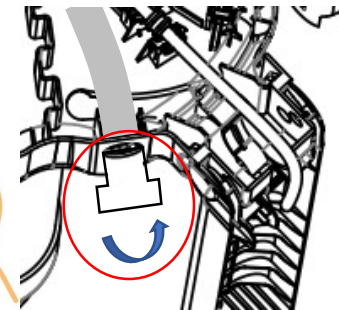

Figure 2C

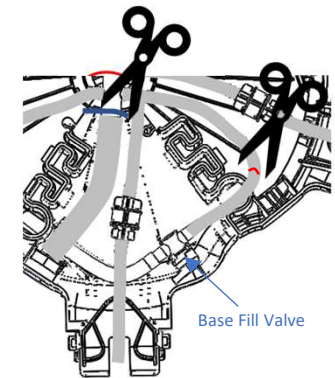

Figure 2D

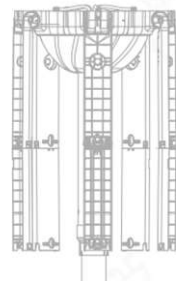

Figure 2E

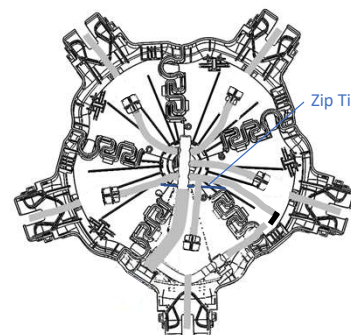

Figure 2F

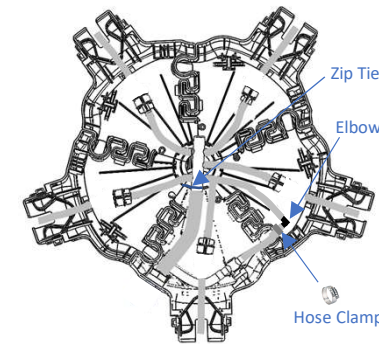

Figure 2G

### 3. Assemble top hub back onto base per instructions in owner manual